

# CRP-RP18-25

## INDUSTRIAL ROBOT HANDLING APPLICATION



### FUNCTIONAL FEATURES

- Equipped with safety emergency stop board which is independent of the control system, and the safety relay circuit is adopted to provide double-circuit emergency stop to ensure the reliability of emergency stop.
- Built-in three-phase filter can effectively improve the performance of internal and external distractions.
- The robot body adopts highly flexible special cable
- The robot body is with dual-circuit gas pipe to meet the handling demands
- J4 axis adopts harmonic reducer structure and the robot body structure has been optimized to improve rigidity so it can meet different handling applications
- Rod joint adopts high protection design so it has longer life span. And the robot has better performance in waterproof and dustproof

### ROBOT BODY TECHNICAL PARAMETERS

Model		CRP-RP18-25
Arm form		Multi joints+connecting rod
Degree of freedom		4 axis
Maximum payload		25KG
Repeated positioning accuracy		±0.08mm
Maximum reaching distance		1885mm
Robot body weight		155KG
Installation mode		Ground
Maximum travel	axis 1	-170°-170°
	axis 2	0°-130°
	axis 3	105°-195°
	axis 4	-360°-360°
Maximum speed	axis 1	172°/S
	axis 2	172°/S
	axis 3	212°/S
	axis 4	350°/S
Allowable torque	axis 4	1.5kg.m <sup>2</sup>
Installation environment	ambient temperature	0-45°C
	relative humidity	20-80% (No condensation)
	vibration	Under 0.5 G
	Others	Robot installation must be away from: flammable or corrosive liquids or gases, electrical sources of interference
IP level		IP56
Advantage features	Compact structure, high speed, high precision, high expansibility and easy operation	
Application	Handling, Assembly	
Electric Cabinet Configuration	G6+External Transformer	

### INSTALLATION INTERFACE DIAGRAM

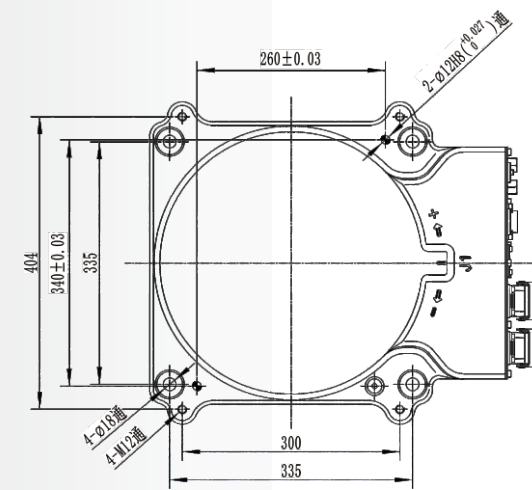

Installation Dimension of Base

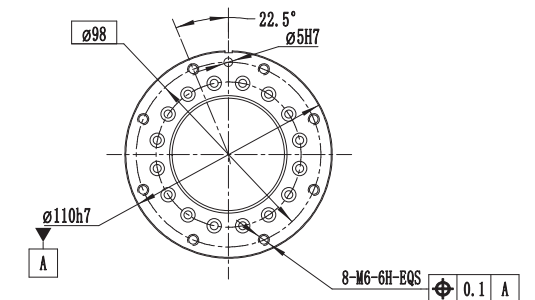

Flange Dimensions

### MOTION RANGE DIAGRAM

