

CRP-RP15-15

INDUSTRIAL ROBOT HANDLING APPLICATION



FUNCTIONAL FEATURES

- With the features of high speed, high precision and high stability, CRP-RP15-15 can be adopted in more application scenarios;
- Rod joint adopts high protection design so it has longer life span. And the robot has better performance in waterproof and dustproof with maintenance-free in usage period;
- Equipped with special punching and palletizing package, customized interface to make operation be more convenient and easy.
- J4 axis adopts higher rigid reducer so the robot has stronger bearing capacity;
- The gravity compensation function ensures the accuracy of the robot at any position;
- Adaptive acceleration can improve the life span of the robot and ensure reasonable acceleration of arbitrary trajectory to achieve more efficient movement

ROBOT BODY TECHNICAL PARAMETERS

Model		CRP-RP15-15
Arm form		Multi joints+connecting rod
Degree of freedom		4 axis
Maximum payload		15KG
Repeated positioning accuracy		±0.05mm
Maximum reaching distance		1530mm
Robot body weight		155KG
Installation mode		Ground
Maximum travel	axis 1	-165°-165°
	axis 2	0°-135°
	axis 3	105°-195°
	axis 4	-360°-360°
Maximum speed	axis 1	230°/S
	axis 2	230°/S
	axis 3	230°/S
	axis 4	550°/S
Allowable torque	axis 4	1.3kg.m ²
Installation environment	ambient temperature	0-45°C
	relative humidity	20-80%(No condensation)
	vibration	Under 0.5 G
	Others	Robot installation must be away from: flammable or corrosive liquids or gases, electrical sources of interference
IP level		IP56
Advantage features	Compact structure, high speed, high precision, high expansibility and easy operation	
Application	Handling, palletizing, depalletizing, stamping, loading and unloading, etc	
Electric Cabinet Configuration		G6

INSTALLATION INTERFACE DIAGRAM

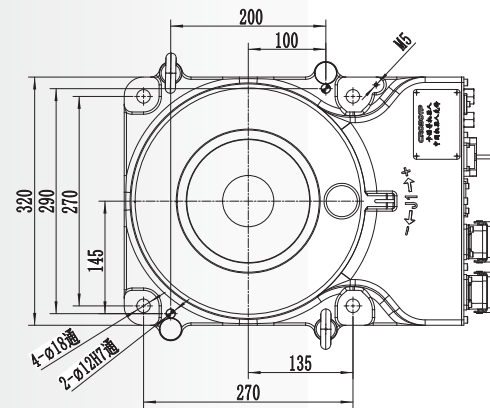

Installation Dimension of Base

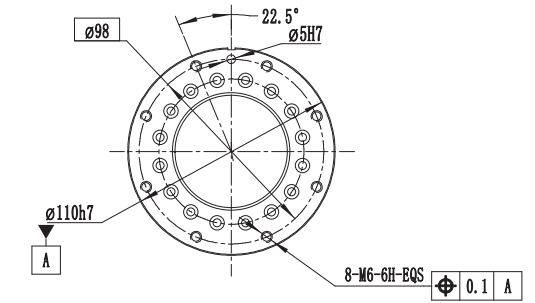

Flange Dimensions

MOTION RANGE DIAGRAM

